

Catching the bus

Catching the bus in the West Midlands is easy.

All bus stops have timetables and flags that show which buses stop there and when. If you are at a bus station with more than one shelter, the flags will show which one you need. At some bus stops you will be able to see how long the next bus will be.



As your bus arrives, **keep back from the edge of the road.** Once the bus has stopped, wait to let any passengers off.

Then get on the bus.

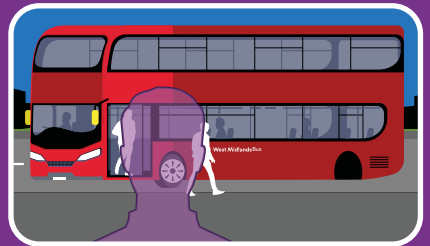

If you have a Swift card, hold the card on the reader until it beeps.

No Swift card? Then just show a bus pass or tell the driver what ticket you need and pay using card or cash.



Find a seat or a handrail to hold onto. Every bus has an area for prams and limited mobility travellers.



Some buses will have announcements for upcoming stops. Or you can look for the screen on the bus showing the next stop.

When you are nearing your stop, press one of the bell buttons on the bus.

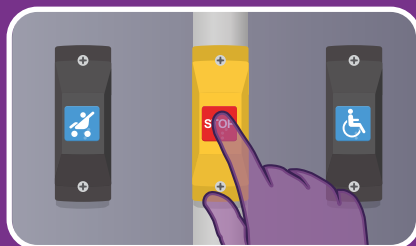

The bus will then stop, and you can get off.

